



PACTO JOYSTICK

Due to its ergonomic and robust design, the Joystick PACTO offers a wide range of installation options. Its modular design and sensitive control allow it to be used ergonomically with the full hand. Further characteristics of the Joystick PACTO are its intuitive use and its long service life. Besides being used in the ACTRAJOY PLUS armrest, the Joystick is predestined for use in customer-specific applications. In addition a micro switch is available on the top of Joystick PACTO. These could be used for e.g. Horn-, release- or customer specific- functions.

- Contactless Hall-effect sensor technology
- Two axes
- Two analogue signals per axis, X characteristic
- Ergonomic design
- Protection class IP 65 if mounted, except plug
- Long service life of 4.0 million cycles except Button (1.0 million cycles)
- EMC in accordance with EN 12895
- Functional safety in accordance with EN ISO 13849, PL C

Transmission protocol

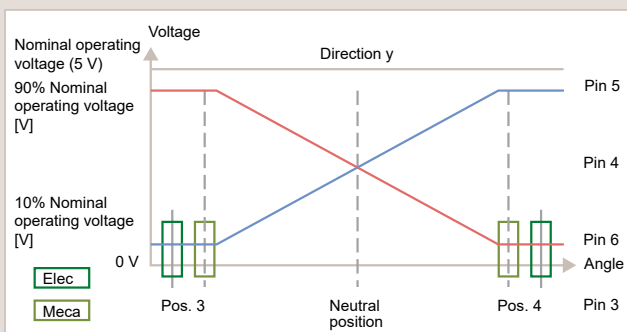
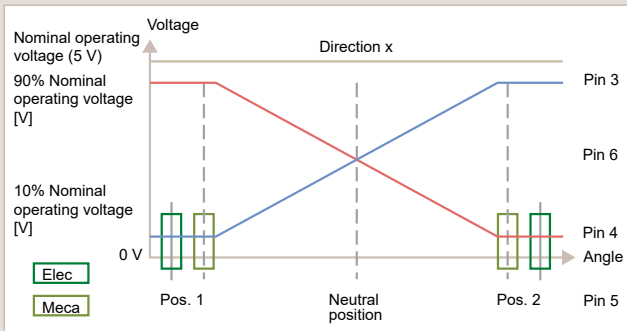

Technical data	
Technology	Contactless hall sensors
Mechanical data	
Dimensions	See drawing
Mechanical angle of rotation	$\pm 20^\circ\text{C}$
Electrical data	
Rated voltage	5 V DC ± 0.02 V
Operating voltage range	4.5 – 5.5 V DC
Power current	< 25 mA
Analogue output ratiometric	X characteristic: 0.5 – 4.5 V DC
Operating conditions	
Operating temperature	-28°C bis +65°C
Storage temperature	-40°C bis +85°C
Maximum force	0.25 Nm
Actuation force	20 Nm
Service life joystick	4.0 million cycles
Service life button	1.0 million cycles
Protection class	IP 65 for assembly
EMC	30 V/M according to EN 12896:2015-09

Connector pin assignment	
8 pin, single row	
PIN 1	Button out
PIN 2	Button in
PIN 3	Signal 2 – 2
PIN 4	Signal 2 – 1
PIN 5	Signal 1 – 2
PIN 6	Signal 1 – 1
PIN 7	GND
PIN 8	+ 5 V

Dimensions [mm]

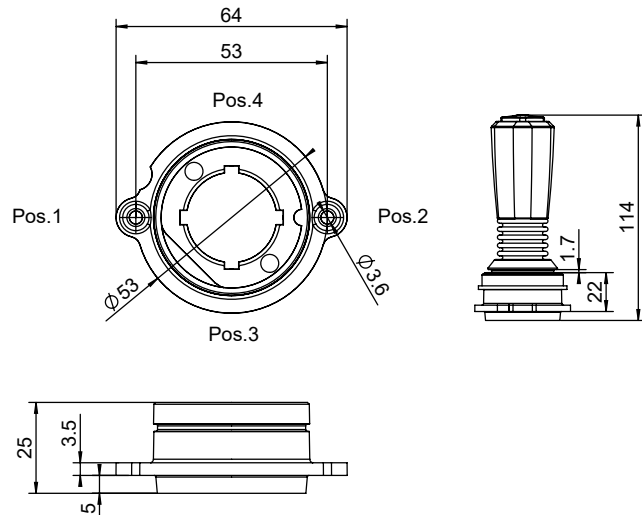

Order data	
Part No.	Designation
3111-012S3-XX	PACTO Joystick