



DC UPS BUFFER MODULE 24 V / 20 A – 480 W

Combined with COMPETENT-COSMO power supply or power pack

- Safety according to VDE 0805 / EN 60950 / IEC 950
- RFI suppression according to EN 55011 class B
- Noise immunity according to EN 50082
- Connection via cage clamp connectors
- Housing width only 70 mm
- Vertically mounted on DIN rail
- Weight approx. 1.2 kg
- Ta 60° C

DC UPS BUFFER MODULE 24 V / 20 A – 480 W

Combined with COMPETENT-COSMO power supply or power pack

- Input 19.2 – 31.2 VDC
- Safety according to VDE 0805 / EN 60950 / IEC 950
- Output voltage range 14.0 – 29.0 VDC
- Adjustable threshold for buffer (freely selectable output voltage range)
- Energy storage: maintenance free capacitors
- Integrated diode coupling
- Indication of operating status
- Parallel use possible
- RFI suppression according to EN 55011 class B
- Noise immunity according to EN 50082
- Connection via cage clamp connectors
- Housing width only 70 mm
- Vertically mounted on DIN rail
- Weight approx. 1.2 kg
- Ta 60° C
- Protective system IP 20



Technical data	
Input	
Nominal voltage	24 VDC
Input voltage range	19.2 – 31.2 VDC
Nominal input current	0.6 A in charge mode
Threshold for UPS adjustable	14.0 – 29.0 V ±1 %
Diode decoupling	Yes
Output	
Output voltage for buffer	14.0 – 29.0 V according to adjusted threshold
Output current	0 – 20 A
Hold-up time	According to load (see table below)
Energy storage	Maintenance free capacitors
Ready signal power good	Output to max 31.2 VDC / 35.0 mA sink
PWF signal power interrupt	Output to max. 31.2 VDC / 35.0 mA sink
Operation display	
“On” indicator (LED) red	Power interrupt
“On” indicator (LED) green flashing	Buffer charging
“On” indicator (LED) green	Buffer ready

Dimensions [mm]	
W x H x L	70 x 126 x 128

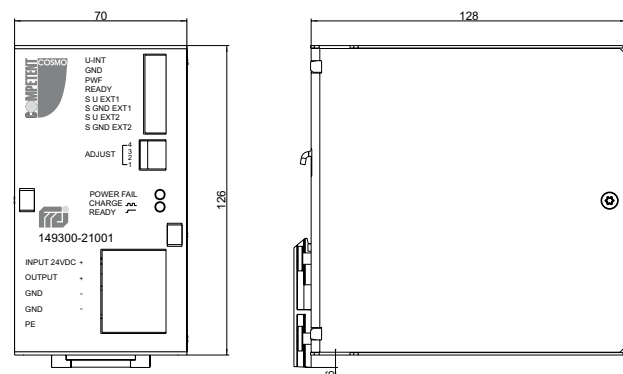

Hold-up time 24 VDC		
Current [A]	Buffer time [s]	
1	4.0	
5	1.0	
10	0.5	
20	0.2	

Ordering data	
Part no.	Ordering text
149300-21001	DC UPS buffer module 24 V / 20 A